

# GET CONNECTED GUIDE

Step-by-step instructions to create your unique ResNet account, start surfing the web and connect the digital devices in your life...



Like a computer



a phone



an iPad



a Blu-Ray  
player



a gaming  
system



or whatever  
you bring!



# RESNET

# CREATE OR RENEW YOUR ACCOUNT

What you will need: 1 Computer, connected to the school network  
Your residence hall and room number  
Your school-issued email address

- ① Visit [www.myresnet.com](http://www.myresnet.com).
- ② If you've never had an account with Apogee, click on the 'Create My Account!' button and begin filling out the requested information to create your new account.
- ③ If you've previously had an account with Apogee, you only need to log in using your existing username and password and select 'Renew My Account' to re-activate your account for the current year. If you can't remember your username and password, click on the 'Forgot your username and password?' link below the login area and enter your PIN or secret security question answer to retrieve your login info.

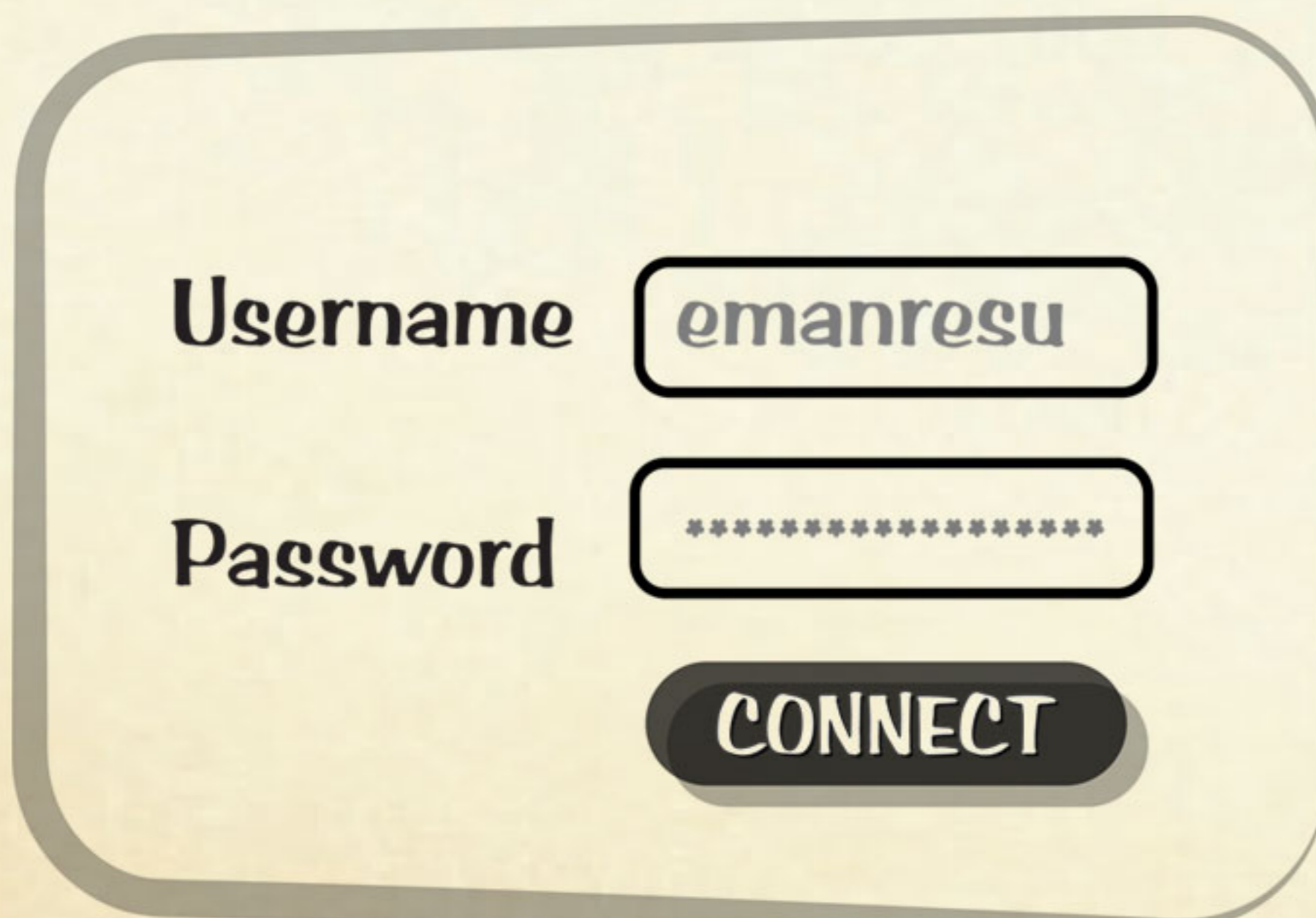

**Username**

**Password**

**CONNECT**

**IMPORTANT:** You'll need to use your login info throughout the year to connect to the network or change your connection speed.

Be sure to print or save your username and password in a safe place!

# CONNECT VIA ETHERNET

**What you will need:**

- 1 Ethernet wall jack
- 1 Computer with a built-in Ethernet port
- 1 Ethernet cable (CAT-V)

- ① Plug one end of your Ethernet cable into your computer's Ethernet port. Plug the other end into the Ethernet jack on the wall. (This looks like a phone cable, but it's slightly larger. If it doesn't fit right, make sure you're using the thicker Ethernet cable and plugging it into the wider port.)
- ② If you have a wireless card, *disable it now*. You want to be sure that your computer is connecting to the internet through the Ethernet network and not over the air.
- ③ Open any internet browser and you'll be automatically prompted to enter your new username and password before you can connect to the internet. If you're not connected within a few seconds, you may need to reboot your computer then try again.

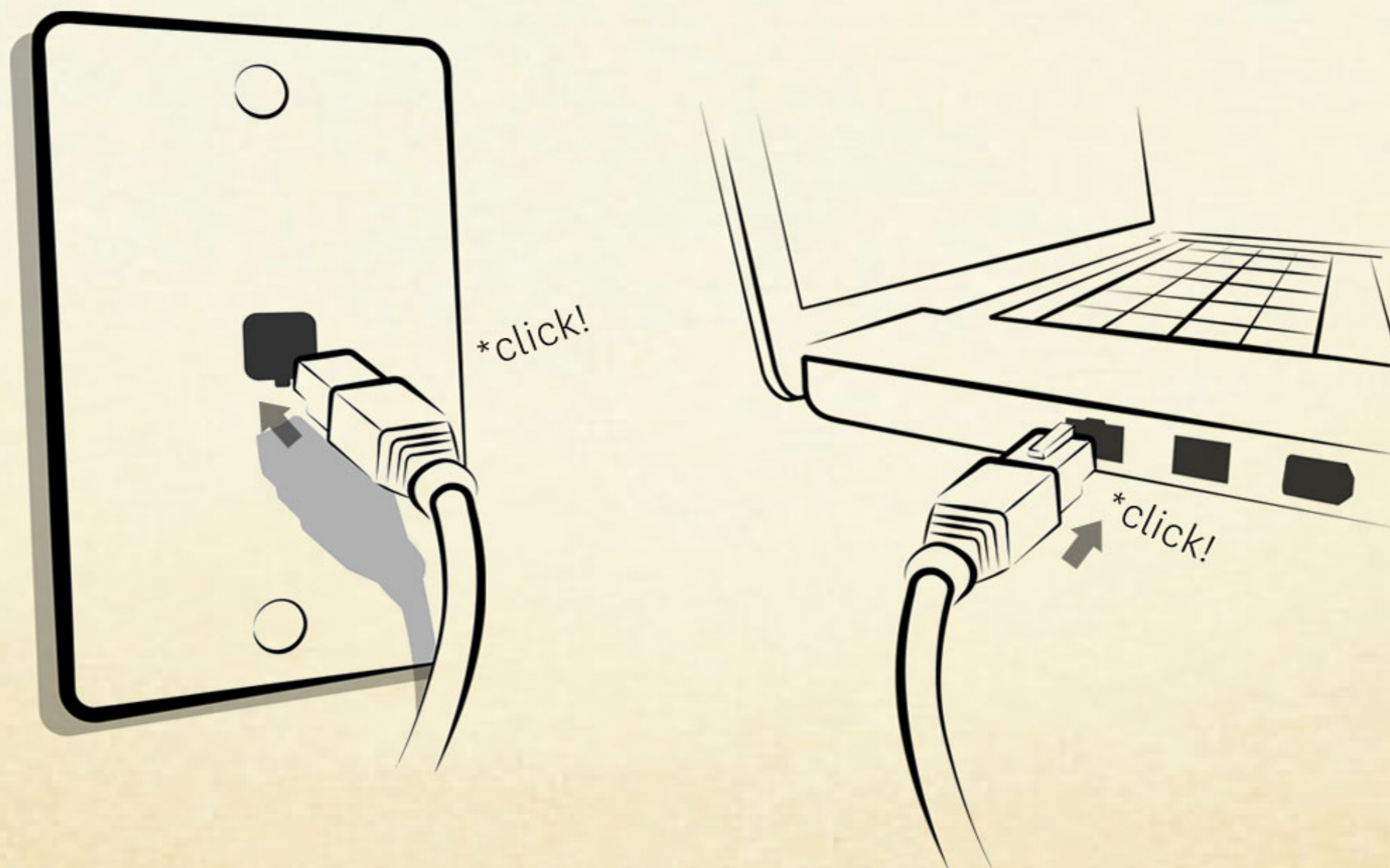

# CONNECT WIRELESSLY



## What you will need:

- 1 Computer with a built-in wireless card

- ① Start by unplugging any other connections. If you sometimes connect to the internet using a wired connection, make sure that your Ethernet cable is unplugged.
- ② View your available wireless networks. On a Windows computer, right-click on the wireless icon in the system tray and choose 'View available networks.' On a Mac, click on the Airport wireless icon in the menu bar (pictured).
- ③ Select the wireless network named '**My ResNet**' or '**Apogee**.' Once your computer has connected to the wireless network, open any internet browser and you'll be automatically prompted to enter your new username and password before you can connect to the internet. If you're not connected within a few seconds, you may need to reboot your computer and try again.

**IMPORTANT!** While wifi is fast and convenient, it's important to remember that broadcasting a wireless signal can be challenging in any high-density residential environment. For more information about these challenges and solutions to achieve the best wireless experience, visit [www.myresnet.com/wifi](http://www.myresnet.com/wifi). If you're having trouble connecting to the wireless network, always let us know by visiting [www.myresnet.com/support](http://www.myresnet.com/support). In every case, remember that connecting with the dedicated Ethernet connection in your room will always be the fastest and most reliable way to access the network.